



# GROUND PROJECTION BARRIER

## FLEXIBLE PLOYMER

### • Innovative three-layered material

- ① Core strength from within.
- ② Central zone for absorbing impact.
- ③ UV-resistant outer color layer.

Molecular reorientation in the manufacturing process results in a distinctive built-in memory, allowing the barrier to fully recover after impacts.

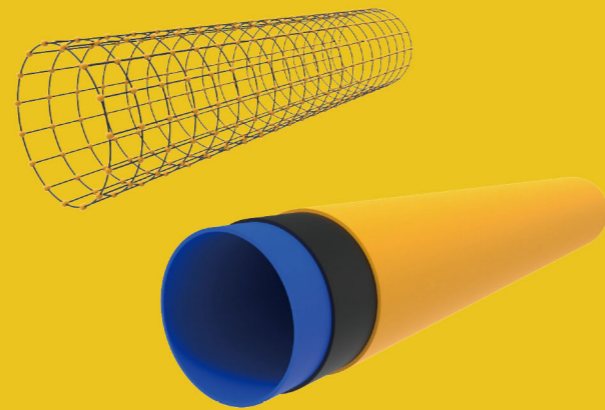

Model	GSR190
Size	190mm*130mm
Length	2000mm
Fixing	8.8 Grade M20 Chemical Bolt
Fixing	8.8 Grade M16 Expansion Bolt
Impact Energy	5800Joule
6tons Forklift hit at	5km/h
Temperature Range	-5~50°C

### • Advantages

- 1. Rubber End Cover
- 2. Quick Disassembly
- 3. Flexible Assembly
- 4. Convenient Maintenance
- 5. Chemical and UV resistance
- 6. Corrosion resistance
- 7. No maintenance
- 8. Safe and non-toxic
- 9. Strong chemical resistance
- 10. No painting required
- 11. Recoverability and Memorability
- 12. Modular combination
- 13. TUV certified
- 14. A tailored solution for every scenario
- 15. Choice of Length
- 16. Deflection at Max Energy : 370mm

### • Applications and typical environments

Aotons Floor Barrier made from high-quality polymer materials, it combines with flexibility, providing excellent protect for walls, forklift charging station, racking system, machinery, storage area. It defends against shallow angular impacts and stops damage from vehicle fork penetration.

Logistics, supply chain and material handling industries	
Transport and logistics centers	Warehouses and storage facilities
Carpark buildings	(Petro-)chemical plants
Distribution centers	and more

### • Fixations

M16 Expansion Bolt    M20 Chemical Bolt

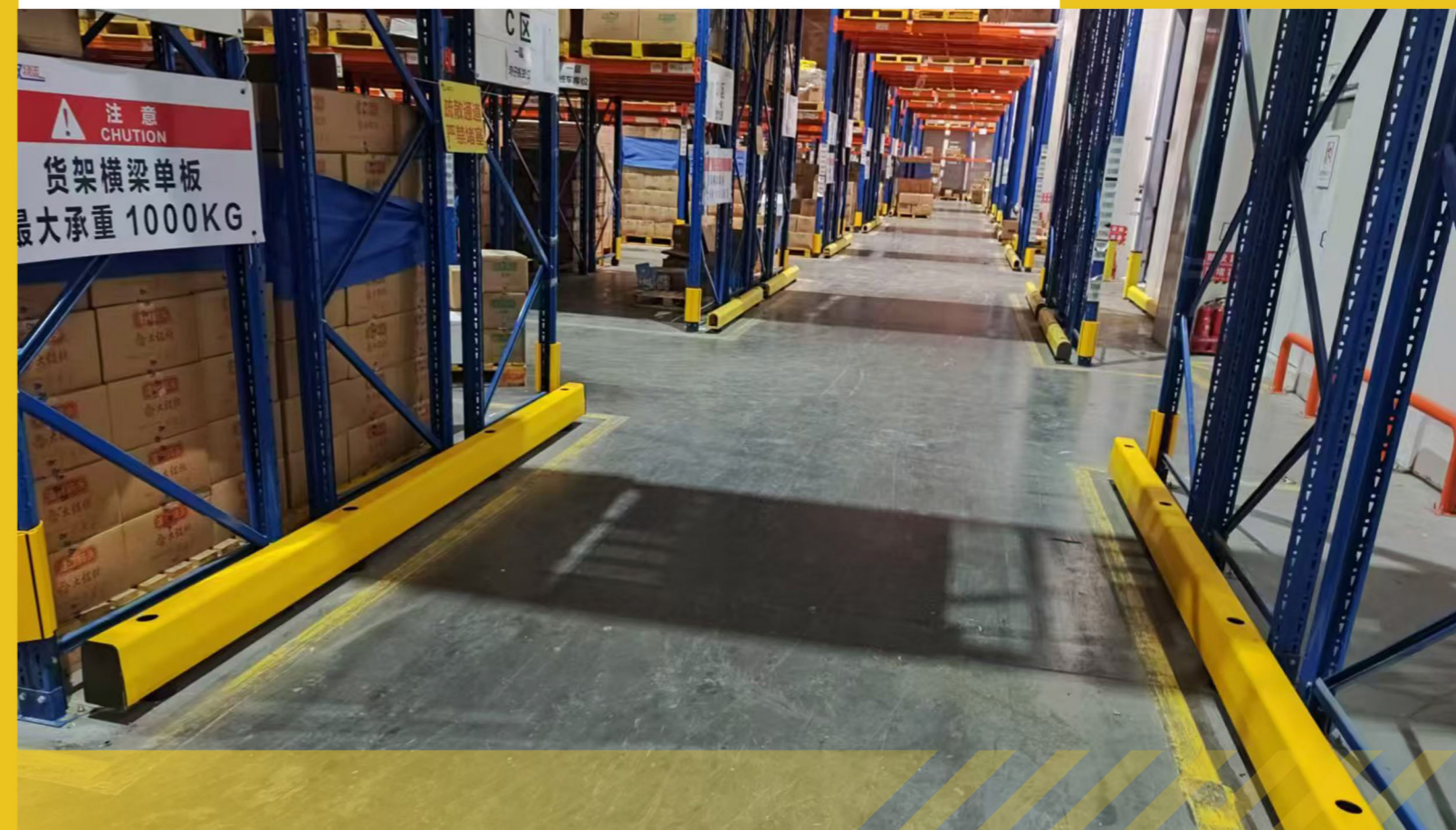

# Dimensions (mm)

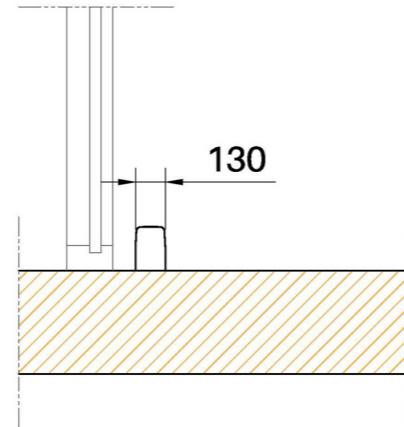
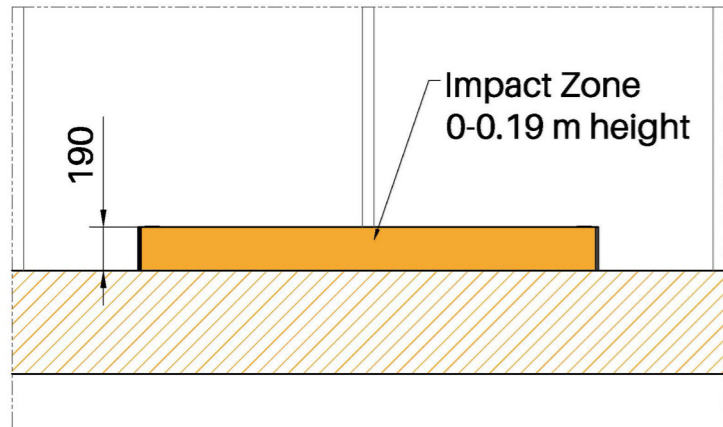

Rated Impact Energy : 5800 Joule  
Rated working angle : 90°  
Rail : RAL 1003 , Signal yellow  
Bolt : 8.8 grade M20 Chemical Bolt  
8.8 grade M16 Expansion Bolt

